

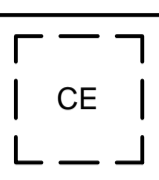











LISTA DE MATERIAL ESGOTO			
MATERIAL	DESCRIÇÃO DOS MATERIAIS	QUANT.	METROS
A	TUBO ESGOTO PVC 100mm	****	54
B	TUBO ESGOTO PVC 50mm	****	18
C	TUBO ESGOTO PVC 40mm	****	06
D	JOELHO 90° 100mm	****	****
E	JOELHO 45° 100mm	****	****
F	JOELHO 90° 50mm	****	****
G	JOELHO 45° 50mm	01	****
H	JOELHO 90° 40mm	05	****
I	JOELHO 45° 40mm	04	****
J	RALO SIFONADO	08	****
K	JUNÇÃO SIMPLES 100X100	04	****
L	REDUÇÃO 100X50	05	****
M	TE 100X50	02	****
N	CAIXA DE GORDURA	02	****

LISTA DE MATERIAL ESGOTO			
MATERIAL	DESCRIÇÃO DOS MATERIAIS	QUANT.	METROS
AA	CONJUNTO DE GRELHA TELA ANTI INSETO	08	****
BB	CAIXA DE INSPEÇÃO DE ESGOTO	01	****
CC	TE 100X100	01	****
DD			
EE			
FF			
GG			
HH			
II			
JJ			
KK			
LL			
MM			
NN			

Legenda

-  Caixa Sifonada
-  Caixas Inspeção Esgoto Simples 600mm x 600mm
-  Caixa de Inspeção/interligação de Esgoto
-  Ralo para Chuveiro Residencial
-  Curva 45° curta
-  Joelho 45
-  Joelho 90- coluna
-  Junção simples
-  Ramais de Ventilação
-  Redução excêntrica- superior
-  Te 45
-  Joelho J90° com visita
-  Curva 90°
-  Ralo

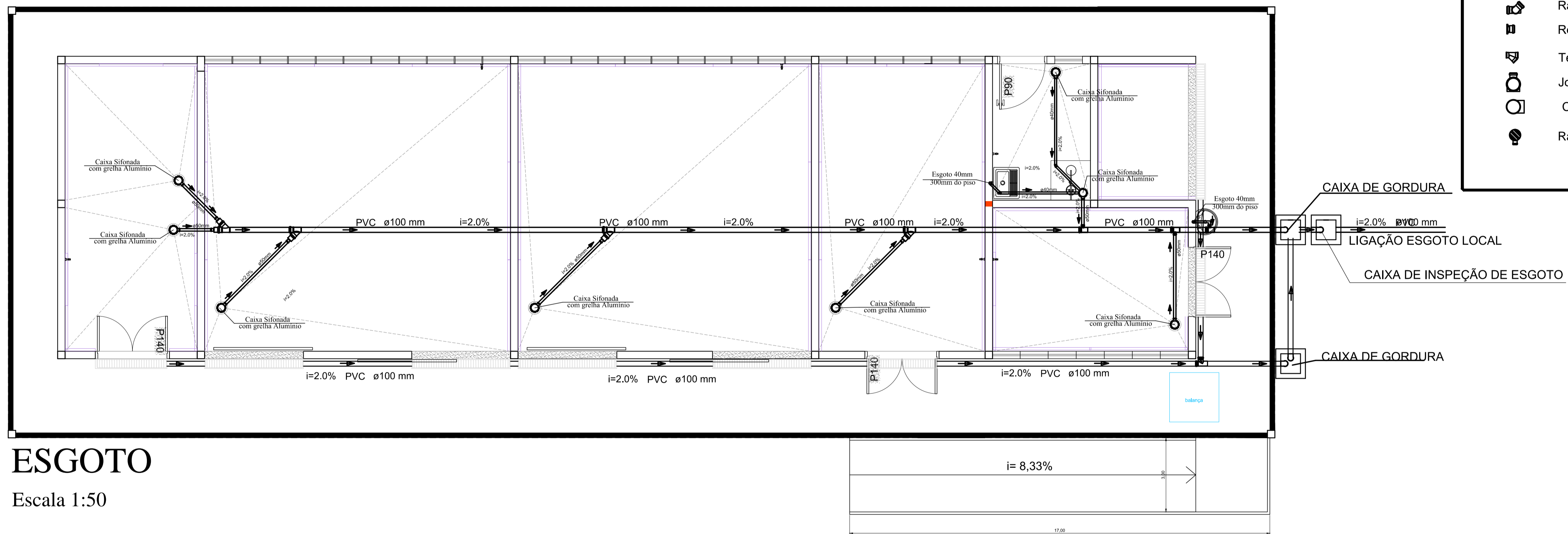

ESGOTO

Escala 1:50

LEGENDA GRUPO DE RESÍDUOS	
	CARRO PARA LIXO 1,20x1,10m
	RALO ESCAMOTEÁVEL EM INOX
	CONJUNTO DE GRELHA E TELA ANTI INSETOS
	LAVA OLHOS COM CHUVEIRO
	BALANÇA PARA PESAGEM DE RESÍDUOS 1.000x1,00m
	TORNEIRA H= 1,10m

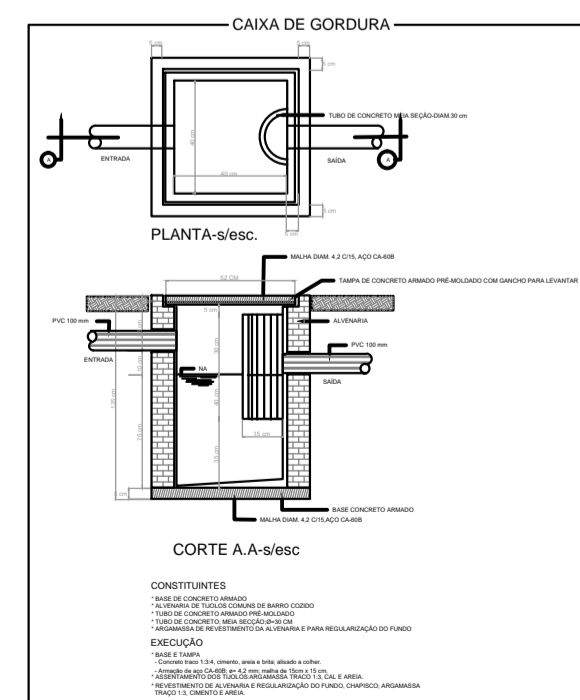
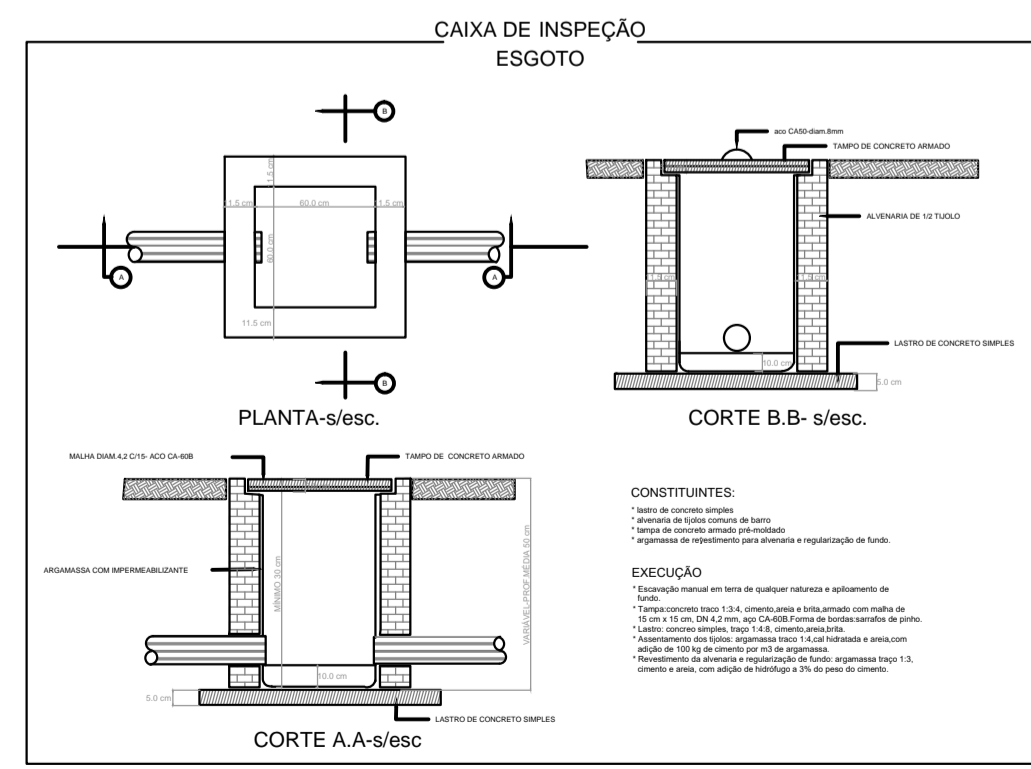

- NOTAS**
1. CONFERIR MEDIDAS NO LOCAL
 2. MEDIDAS EM METRO, EXCETO ONDE INDICADO



SÃO PAULO
GOVERNO DO ESTADO

Secretaria de Saúde

CAISM - PHILIPPE PINEL



GRUPO TÉCNICO DE EDIFICAÇÕES

ABRIGO DE RESÍDUOS

Av. Dr. Enéas Carvalho de Aguiar, nº 188, 3ª andar
São Paulo-SP Cep 05463-000
Tel. (11)3066 8420 Fax (11)3066 8482

HIDRAULICA - PROJETO ESGOTO

H-016

HID-FL01/06

DIRTOR DO S.T.E.
Engº YUKIO KITAMURA
ARQUITETO
Arq. CÂMLIO CHINGOTTE

DATA: NOV/2020